

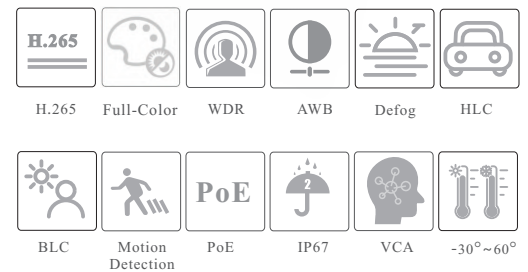

VTD-9452C1-A 5MP Full-Color Bullet Network Camera



- 5MP (2592 × 1944) H.265 full real time coding
- Max. resolution: 2592 × 1944
- 24/7 full color imaging
- 20 ~ 30m white light view distance
- 3D DNR, true WDR, HLC, BLC, Defog, and ROI coding
- 1CH audio input
- Built-in micro SD card slot, up to 256GB
- DC12V/PoE power supply
- IP 67 ingress protection
- Support three streams
- Support remote monitoring by smart phones & tablet PCs with iOS and Android OS
- Intelligent analytics



SPECIFICATIONS

Specifications	Model	VTD-9452C1-		
Camera				
Image Sensor		1 / 2.7 "CMOS		
Image Size		2592 × 1944		
Electronic Shutter		1 / 2 s ~ 1 / 100000 s		
Iris Type		Fixed Iris		
Min. Illumination		0.006 Lux@F1.0, AGC ON; 0 Lux with LED ON, AGC ON		
S/N Ratio		≥50dB		
Lens		2.8 mm@F1.0, horizontal FoV: 97°; vertical FoV: 72°; diagonal FoV:128° 3.6 mm@F1.0, horizontal FoV: 78°; vertical FoV: 58°; diagonal FoV:101°		
Focus		Fixed		
Lens Mount		M12		
Wide Dynamic Range		120dB		
BLC		Yes		
HLC		Yes		
Defog		Yes		
Digital NR		3D DNR		
Angle Adjustment		Pan: 0°~360°; Tilt:0°~90°; Rotation: 0°~360°		
Image				
Video Compression		Main stream: H.265+ / H.265 / H.264+ / H.264 Sub stream: H.265+ / H.265 / H.264+ / H.264 / MJPEG Third stream: H.265+ / H.265 / H.264+ / H.264 / MJPEG		
H.264 Compression Standard		Baseline Profile/Main Profile/High Profile		
Resolution		5MP (2592×1944), 4MP (2592×1520), 2K (2560×1440), 3MP(2304×1296), 1080P (1920×1080), 720P (1280×720), D1, CIF, 480×240		
Main Stream		5MP/4MP/2K/3MP/1080P / 720P (60Hz: 1 ~ 30fps; 50Hz: 1~25fps)		
Sub Stream		720P/D1/CIF/480×240 (60Hz: 1 ~ 30fps; 50Hz: 1~25fps)		
Third Stream		D1/CIF/480×240 (60Hz: 1 ~ 30fps; 50Hz: 1~25fps)		
Bit Rate		64 Kbps ~ 8 Mbps		
Bit Rate Type		VBR / CBR		
Audio Compression		G711A / U		
Image Settings		ROI, Saturation, Brightness, Hue, Contrast, Wide Dynamic, Sharpness, Image Flip, Image Mirror, NR, etc. adjustable through client software or web browser		
ROI		Each ROI to be configured separately		
Interfaces				
Network		RJ45		
Video Output		No		
Audio		1CH audio input		
Storage		Built-in micro SD card slot; up to 256GB		
Reset		Yes		
Alarm		No		
Intelligent Analytics (Smart Events)				
Perimeter Protection		Line crossing, region entrance/exiting/intrusion (human/motor vehicle/non-motor vehicle classification)		
Statistics		Target counting by line/area, heat map		
Exception Detection		Scene change, video blur and video cast detection		
Face Detection		Face detection and face capture		
Other Events		Abandoned/missing object detection, crowd density detection		
DORI Distance				
Lens	Detect	Observe	Recognize	Identify
2.8mm	53.51m(175.55ft)	21.40m(70.20ft)	10.70m(35.10ft)	5.35m(17.55ft)
3.6mm	70.14m(230.11ft)	28.05m(92.02ft)	14.02m(45.99ft)	7.01m(22.99ft)
Functions				
Remote Monitoring		Web Browser/TVT NVMS2.0/NVR/mobile APP		
Web Browser		IE(plug-in required)/Google Chrome/Edge/Firefox/Safari		
Online Connection		Support simultaneous monitoring for up to 10 users; Support multi-stream real time transmission		

Network Protocol	UDP, IPv4, IPv6, DHCP, NTP, RTSP, RTP, RTCP, PPPoE, DDNS, SMTP, FTP, SNMP, HTTP, 802.1x, UPnP, HTTPs, HTTP POST, RTMP, QoS
Interface Protocol	ONVIF
Storage	Network remote storage; micro SD card storage
Smart Alarm	Motion detection, SD card error, SD card full
General Function	Watermark, IP address filtering, video mask, heartbeat, illegal login lock, corridor pattern
PoE	Yes, IEEE802.3af
White Light Range	20~30 m
Ingress Protection	IP67
Others	
Power Supply	DC12V/PoE
Power Consumption	< 7W
Storage Conditions	- 30 °C ~ 65 °C (-22°F~149°F), Humidity: less than 95 % (non-condensing)
Operating Conditions	- 30 °C ~ 60 °C (-22°F~140°F), Humidity: less than 95 % (non-condensing)
Dimensions (mm)	217.8 × 80.5 × 80.3
Weight (net)	Approx. 0.68KG
Installation	Ceiling mounting; Wall mounting
Certificate	CE, FCC
Environmental Protection	Complies with Directive EU RoHS, WEEE(2012/19/EU), directive 94/62/EC and REACH(EC1907/2006)

DIMENSIONS

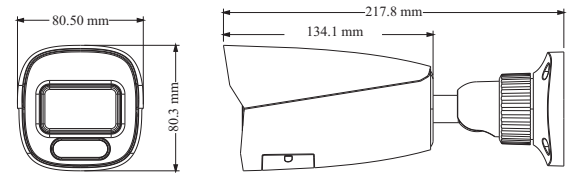

AVAILABLE ACCESSORIES



AVAILABLE MODEL

Available Model	VTD-9452C1-A(PE/WR2)	Fixed lens
-----------------	----------------------	------------